

# CORDRAIN™ Installation Guide/Do's & Don'ts

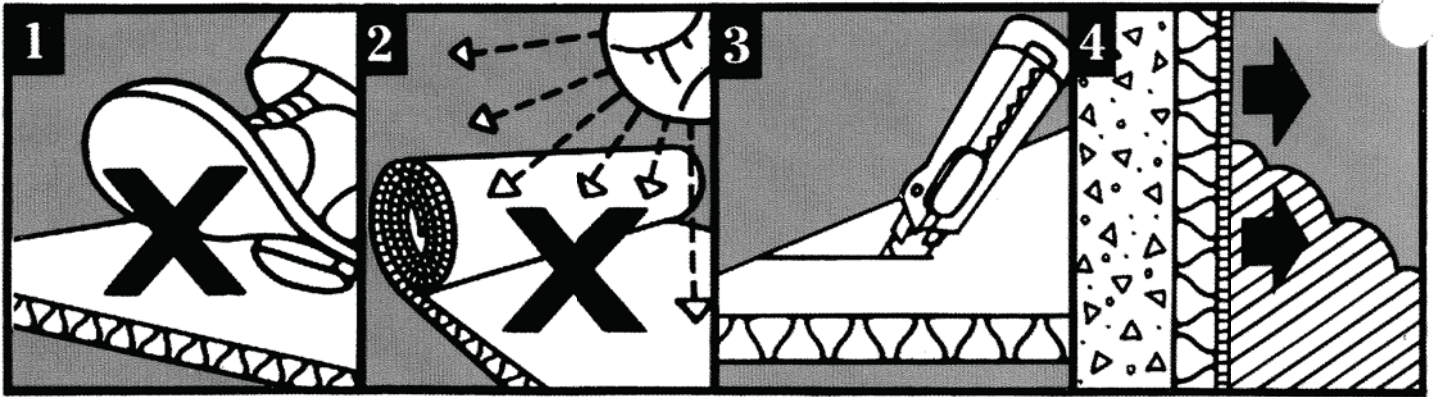

1 To ensure the geotextile filter is not damaged, do not walk, or place heavy materials on it.

2 Keep wrapped until ready to use to minimise harmful effects of sunlight. Bury as soon as possible. Once installed do not leave exposed for more than 1-2 weeks.

3 Cutting method: **Cordrain** can be readily cut with most commonly available cutting blades such as a Stanley knife or NT cutter.

4 Always face the geotextile filter fabric to the soil you wish to be drained.

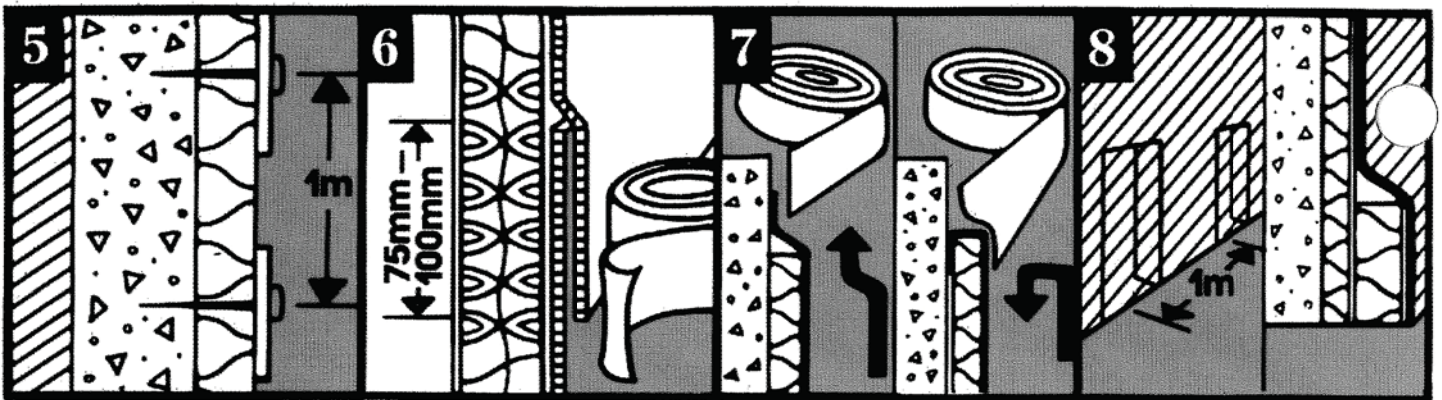

5 Fix with masonry nails through a 50mm x 50mm pad of plywood or other suitable material at one metre centres. **OR** Fix to wall with **CONTACT** adhesive covering 4 to 6 tips at one metre centres if waterproofing materials have already been applied to walls.

6 Join sheets horizontally by overlapping the top core layer over the lower one by 75-100mm. The top geotextile is then lapped over the lower geotextile filter fabric and taped. Vertical joints are made similarly by over-wrapping cores and filter fabrics and taping the top filter fabric down. (Suggested tape PVC Duct Tape, preferably 100mm).

7 At top of the **Cordrain** excess filter fabric must either be turned over the top and back onto the core, or secured against the walls to prevent backfill from entering the core.

8 For retaining walls using weep holes, the core only at the base must have cutouts 50 x 12mm at 1.0m centres (need not align with weeps holes). **DO NOT CUT FILTER FABRIC.** When weep holes are not used, a basal drain should be installed as a base drain by inserting under **Cordrain** geotextile.

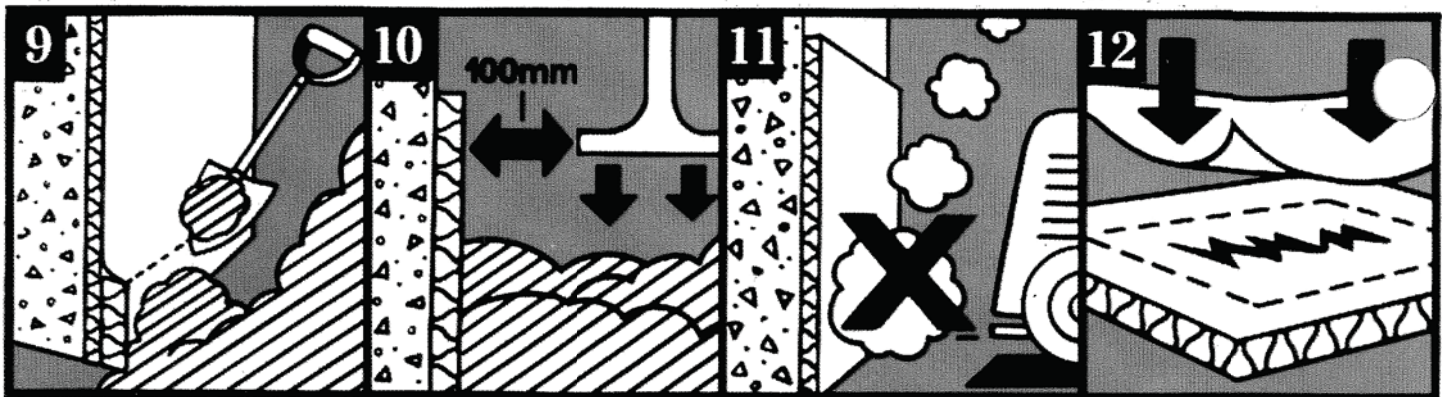

9 Backfilling should commence by hand around the base of drain but can be completed mechanically. Care should be taken to prevent damage to **Cordrain** during backfilling. It is advisable to temporarily protect the **Cordrain** with a plywood sheet that is raised as work proceeds. Backfill with sharp stones or rock is not recommended.

10 **Cordrain** can withstand the lateral load applied by compaction equipment up to 100mm from the face.

11 Machinery exhausts should be pointed away from **Cordrain** when compacting as excessive heat can cause damage.

12 Should a cut occur in the geotextile then it should be taped over to ensure that no soil can enter the drain. If a large area of geotextile is torn, a patch of geotextile should be placed over the area and taped, allowing an overlap of 100mm.

## MACCAFERRI

GEOSYNTHETICS, RETAINING, REINFORCED SOILS, ROAD REINFORCEMENT, EROSION, DRAINAGE, LANDSCAPING, CONTAINMENT SYSTEMS, HYDRAULIC STRUCTURES, COASTAL PROTECTION, BUILDING

Maccaferri NZ Ltd

**Auckland**  
14 Goodman Place, P O Box 12536, Penrose  
Auckland, New Zealand  
Tel: (64) 9 634 6495  
Fax: (64) 9 634 6492  
sales@maccaferri.co.nz  
technical@maccaferri.co.nz  
Quality System Certified AS/NZS.ISO 9001

**Christchurch**  
158 Waterloo Road, Hornby  
P O Box 6227 Upper Riccarton  
Christchurch, New Zealand  
Tel: (64) 3 349 5600  
Fax: (64) 3 349 5004  
christchurch@maccaferri.co.nz

**Napier**  
Tel: 0800 60 60 20  
Fax: (06) 835 6647  
napier@maccaferri.co.nz  
**Associate Branches**  
Suva, Fiji  
Noumea, New Caledonia  
Lae, Papua New Guinea



Engineered Environmental Solutions

**FREEPHONE 0800 60 60 20**